

# Residential Building 5,000 SQM For Sale

**€7,000,000 Offers in region of**

Mesa Chorio, Paphos

## Key Facts

- 5,000 m<sup>2</sup> Covered Area
- 10,954 m<sup>2</sup> Land Size
- Title Deed: Available

**ID: 13442**



## Indoor Features

- Security System
- EPC Energy Class: Pending

## Outdoor Features

- Communal pool
- Private pool

## Description

### Luxury Residential Project

This residential development features primary residence for all family sizes and includes:

- 11 Private villas with private pools which consists of 2,3, and 4 bedrooms villas
- 15 Townhouses with 2 bedrooms each and a community pool
- Land 10,954 sq. meters
- All Properties have their own individual title deed
- See the actual allocation of the properties on the attached chart

This fantastic project has been built on a large plot of land. The properties themselves are modern and have been constructed with only the finest of materials. Each unit features a large private terrace with lovely views of the coast.

Once inside the residences you will find an open plan layout with a contemporary interior design giving you a warm and friendly home for comfort. Great care has been taken to ensure that the properties offer a family friendly environment for living in Cyprus

The community has a serene, peaceful feeling that combines the ease of your daily commute. There's no traffic that passes by, as the project is built on a private and quiet location with stunning sea views of the Paphos coast.

Mesa Chorio is one of the most sought after areas in Paphos, which is close to the International School, numerous championship golf courses, and all the amenities that makes this area one-of-a-kind.

It has long been known as one of the hidden gems of Paphos, and is a serene and tranquil location surrounded by green views aplenty, perfect for those looking to achieve a peaceful lifestyle and calm atmosphere for living in Cyprus.

A favorite destination for the upper class residents of Cyprus who chooses to make a home here, Mesa Chorio is a safe and lovely spot for those with children and offers a full range of excellent amenities all within a short distance from your home – giving you everything you need for your day to day living close at hand.

## Indoor

- » Maids quarters
- » Granite kitchen worktops
- » Marble staircase
- » Basement
- » Wi-Fi
- » Satellite
- » Open Kitchen
- » Separate Kitchen
- » Air Conditioning
- » Central Heating

## Outdoor

- » Private swimming pool
- » Communal swimming pool
- » Private parking
- » Barbeque Area
- » Solar System
- » Stone Decorated
- » Security Alarm
- » Jacuzzi
- » Storage room
- » Roof garden
- » Automatic irrigation system
- » Mature landscaped garden

## Views / Distances

- » Sea views
- » Mountain views
- » Airport:30 min drive
- » Town: 5 min drive
- » Beach: 15 min Drive
- » Golf: 15 min Drive



















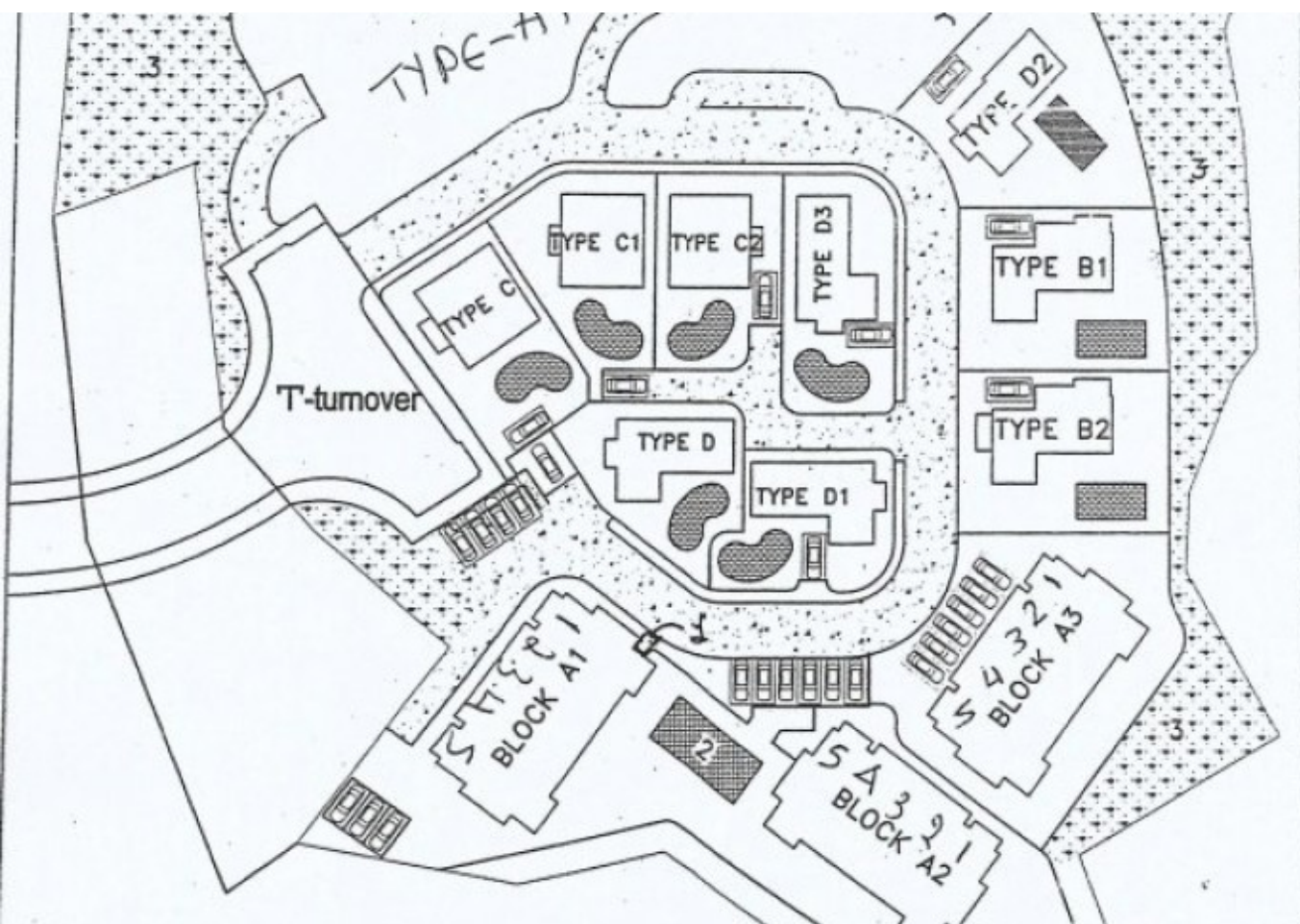

TYPE	BASEMENT m2	GROUND m2	1st m2	COVERED VERANDAS m2	UNCOVERED VERANDAS m2	POOL m2	POOL PATIO m2	BEDROOM
VILLA TYPE-A1	223	177	177	103	33	CONC. 9.5X5	279	4 bedroom house with basement
VILLA TYPE-A2	223	177	157	104	34	CONC. 9.5X5	290	3 bedroom house with basement
TYPE B1	NO	82	55	25	41	PREFAB. 7X3.5	34	3 bedroom villas
TYPE B2	NO	82	55	25	41	PREFAB. 7X3.5	34	3 bedroom villas
TYPE C	NO	68	60	12	9	KIDNEY 8X4	51	2 bedroom villas
TYPE C1	NO	68	60	12	9	KIDNEY 8X4	53	2 bedroom villas
TYPE C2	NO	68	60	12	9	KIDNEY 8X4	72	2 bedroom villas
TYPE D	NO	66	52	13	19	KIDNEY 8X4	36	3 bedroom villas
TYPE D1	NO	66	52	13	19	KIDNEY 8X4	53	3 bedroom villas
TYPE D2	NO	66	52	13	19	PREFAB. 7X3.5	42	3 bedroom villas
TYPE D3	NO	66	52	13	19	KIDNEY 8X4	69	3 bedroom villas
BLOCK A1 mezonettes	NO	220	194	51	74	CONC. 9 x 4.5m		2 bedroom mezonettes
BLOCK A2	NO	220	194	51	74		120	AREA OF EACH MEZONETTE